

Room 55 Dual and Inogeni 4KX-PLUS
 For USB Passthrough - with Inogeni at table
 Line drawing

4KX-PLUS INSTALLATION
 THE ADVANTAGE TO PLACING THE INOGENI AT THE TABLE is twofold:
 1) it is not necessary to extend USB
 2) If more than one computer is used for USB Passthrough, the Lightware or other switcher can also be at the table, simplifying wiring.

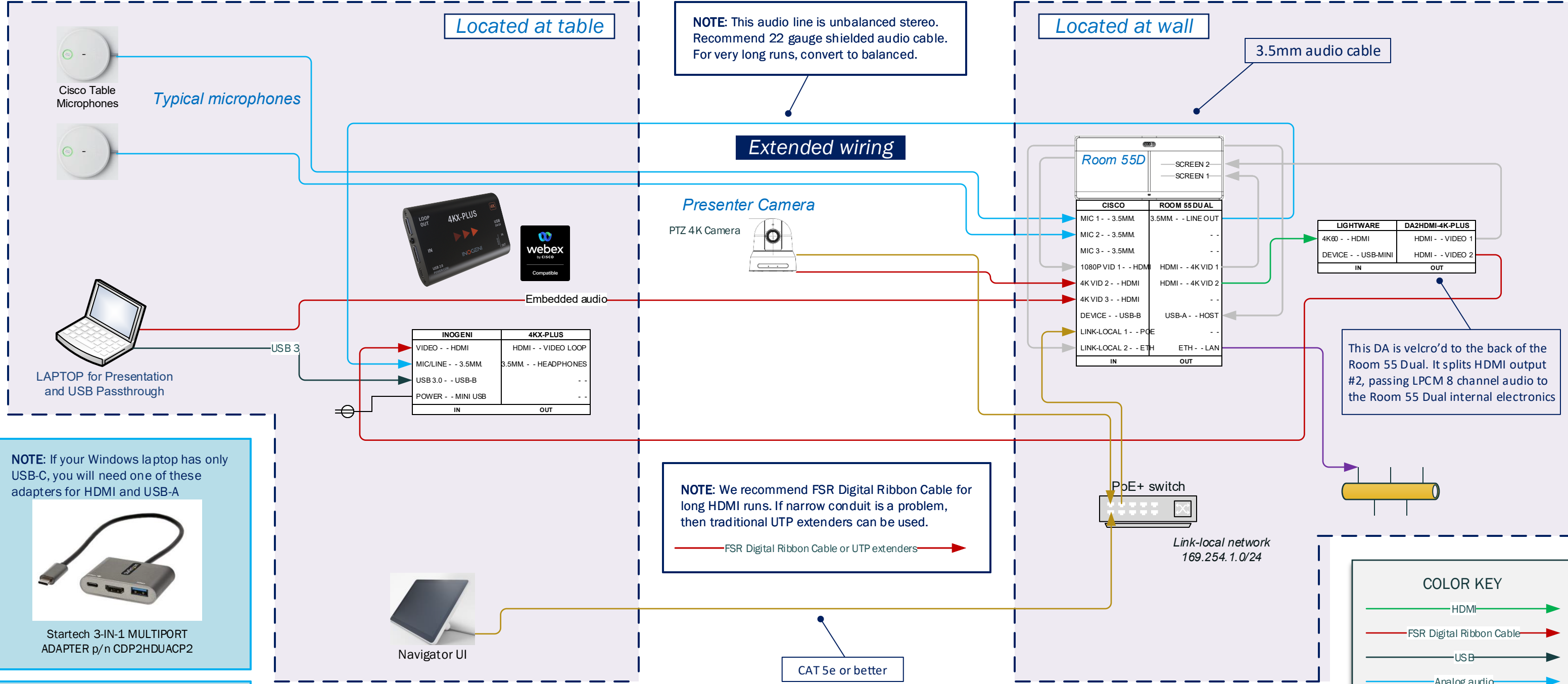

NOTE: If your Windows laptop has only USB-C, you will need one of these adapters for HDMI and USB-A



Startech 3-IN-1 MULTIPORT ADAPTER p/n CDP2H DUACP2

NOTE: MacBook users - you are accustomed to dongles ☺ One that will work is the Apple USB-C Digital AV Multiport Adapter



This drawing also applies to the Room 70 Dual Gen 1